



Ground power unit GPU 17





7kVA – 115/200V 400Hz or 120/208V 400 Hz

28V_{DC} – 400A

Designed for helicopters MI-17, MI-171Š, MI-24 type



 **PBS** VELKÁ BÍTEŠ a.s.

-  Lightweight
-  Compact
-  Efficient
-  AC / DC output
-  Transportable by helicopter (incl. Mi-24)

Characteristics

AC output

Permanent power	7 kVA at power factor 0,8 - 1
Overloading	10 kVA 5 min, 14 kVA 5 sec
Voltage	3x 115/200 V or 3x120/208 V
Frequency	400 Hz
Voltage regulation and quality	ISO 6858

DC output

Permanent power	11,4 kW
Permanent current	400 A
Overloading	800 A, 5 sec
Voltage	28,5 V _{DC}
Voltage regulation and quality	ISO 6858

Weight	Standby 247 kg	Connection cables + spool 64 kg
	Without battery, fuel and exhaust pipe 180 kg (manual manipulation)	

PBS Velká Bíteš, a.s. - Aircraft technique division

Vlkovská 279, 595 12 Velká Bíteš Czech Republic

<http://www.pbsvb.cz>, e-mail: sales@pbsvb.cz, Tel: +420 566 822 304, Fax: +420 566 822 372



Ground power unit GPU 17

Engine

- Gas turbine
- Fuel - kerosene
- Speed 40 180 rpm
- Electronic controlling
- Battery 1x 24V-27 Ah (VARTA F20/27 H1C M1 (Mi-24))

AC alternator

- BFL 7-9/4 type
- 400 Hz
- 115/200V or 120/208V
- Speed 12 000 rpm
- Electronic regulation

DC startergenerator

- APC 400SG 121Q type
- 28,5 V_{DC}
- Speed 10 060 rpm
- Electronic regulation

Protections

Electric

- Under-/over voltage
- Under-/overfrequency
- Overloading
- System insulation state failure

Engine

- Exhaust gas temperature
- Oil pressure
- Filter contamination
- Engine diagnostics

Outputs

- 1x AC output** with switchable voltage 115/200V-400Hz or 120/208V-400Hz 12 m cable length, connector ŠRAP 400 3F
- 2x DC output** 1x 12 m cable length, connector ŠRAP 500K
- 1x panel connector 2RMDT30BPN8G7V1
- (external supply possibility 28,5V_{DC}, 100A max.)

Operation

- Easy operation
- Operation, service and malfunction indicated by multifunctional VFD display
- Diagnostics by enclosed software and RS 232 connection

Characteristics

- Aluminum structure
- The spool with the cables is part of GPU 17. The spool is containing the box for necessary accessories
- Tilt wheels and exhaust tube dismounting possibility for dimension reduction (transportable in Mi-24)
- Fuel tank 33 l
- Operation time at one fuel tank - min 1 hour
- Temperature range -30 °C ÷ +44 °C
- Altitude 0 ÷ 3 000 m

GPU 17 =

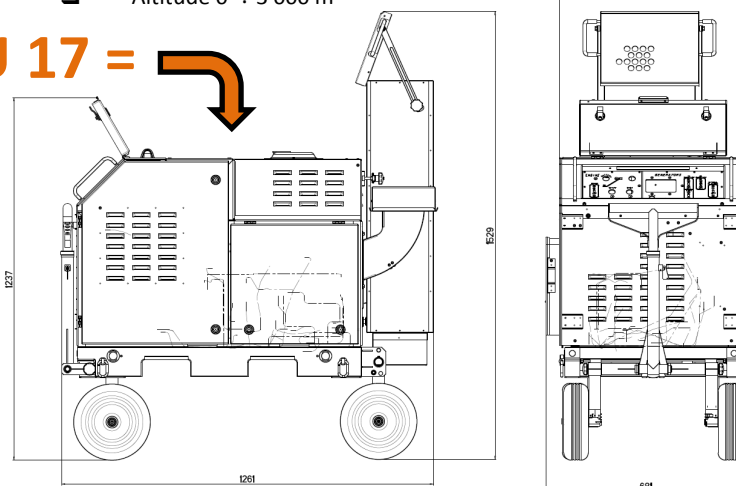

Stand by dimensions

Weight 247 kg



Weight 64 kg

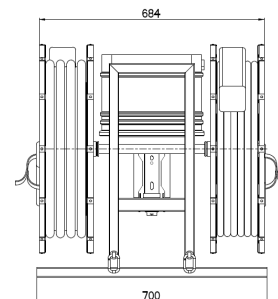
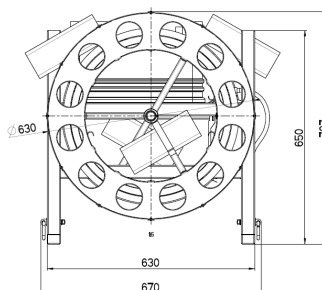

Cable spool



Transportation in Mi-24



Standard connection to helicopter